

Hydraulic Control Unit (HCU)

Material

Item	Specification
High Performance DOT 3 Motor Vehicle Brake Fluid PM-1-C (US); CPM-1-C (Canada)	WSS-M6C62-A or WSS-M6C65-A1

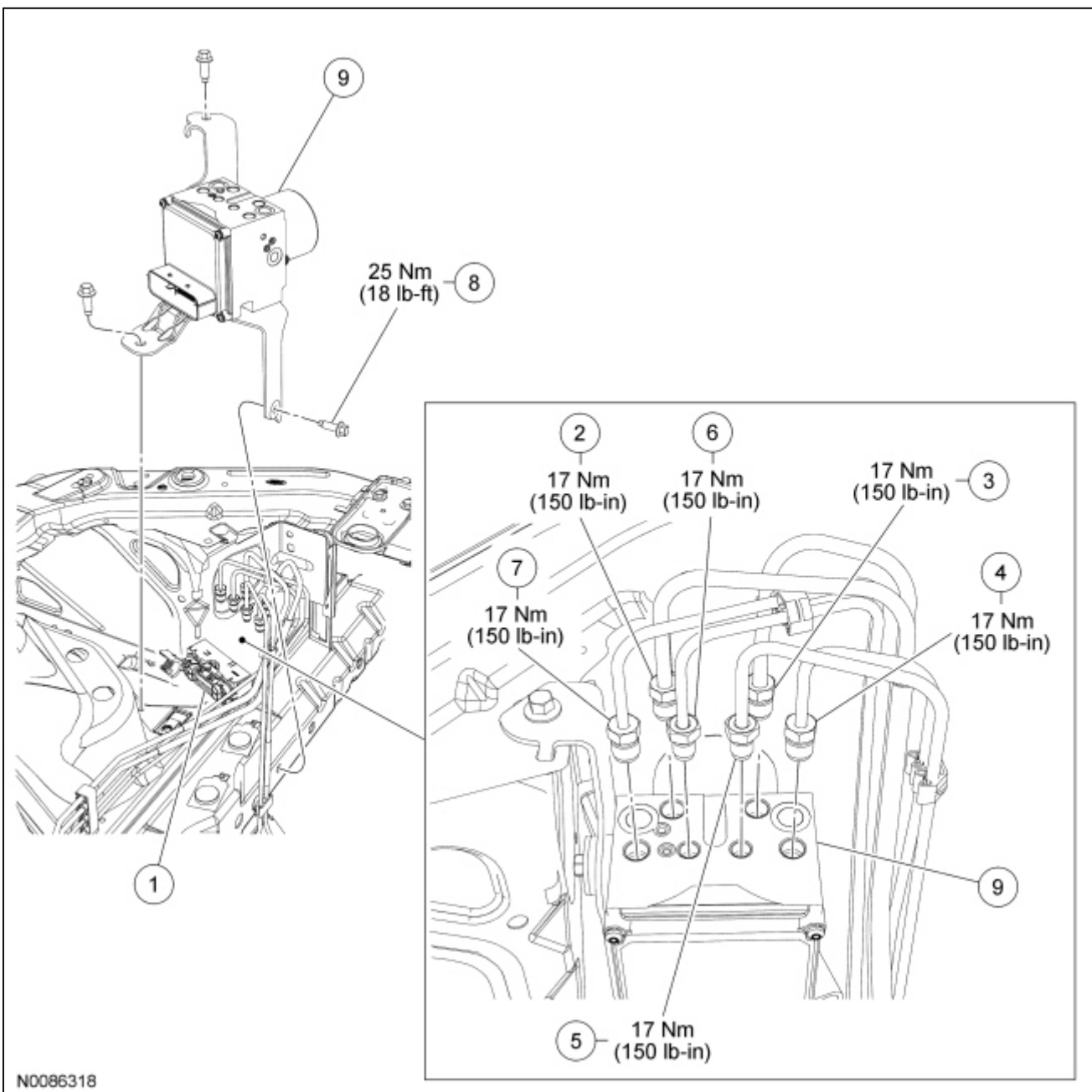

Item	Part Number	Description
1	—	ABS module electrical connector (part of 14A005)
2	—	Master cylinder primary brake tube (part of 2269)

3	—	Master cylinder secondary brake tube (part of 2269)
4	—	RH front brake tube (part of 2C296B)
5	—	LH front brake tube (part of 2C296A)
6	—	RH rear brake tube fitting (part of 2C360)
7	—	LH rear brake tube fitting (part of 2C360)
8	W500223	Hydraulic Control Unit (HCU) bracket-to-frame bolt (3 required)
9	2C215	HCU

Removal and Installation



WARNING: Do not use any fluid other than clean brake fluid meeting manufacturer's specification. Additionally, do not use brake fluid that has been previously drained. Following these instructions will help prevent system contamination, brake component damage and the risk of serious personal injury.



WARNING: Carefully read cautionary information on product label. For EMERGENCY MEDICAL INFORMATION seek medical advice. In the USA or Canada on Ford/Motorcraft products call: 1-800-959-3673. For additional information, consult the product Material Safety Data Sheet (MSDS) if available. Failure to follow these instructions may result in serious personal injury.

NOTICE: Do not spill brake fluid on painted or plastic surfaces or damage to the surface may occur. If brake fluid is spilled onto a painted or plastic surface, immediately wash the surface with water.

1. Remove the air cleaner assembly. For additional information, refer to [Section 303-12](#).
2. Disconnect the ABS module electrical connector.
3. **NOTE:** Brake tubes must be installed in the same location as removed.

Loosen the 6 brake tube-to-Hydraulic Control Unit (HCU) fittings, disconnect and position the brake tubes aside.

- To install, tighten to 17 Nm (150 lb-in).
4. Remove the 3 [HCU](#) bracket-to-frame bolts.
 - To install, tighten to 25 Nm (18 lb-ft).
 5. Remove the [HCU](#) assembly.
 6. If necessary, remove the [HCU](#) bracket-to- [HCU](#) bolt and the bracket.
 - To install, tighten to 11 Nm (97 lb-in).
 7. To install, reverse the removal procedure.
 - Bleed the brake system. For additional information, refer to [Section 206-00](#).
-

